

- Positive Shut Off Eliminates Backflow Into Bolt
- Bend Resistant Tip
- Adjustable Range of 0"-1"
- Re-adjustable Design Provides Complete Flexibility In Installed Sensor Placement
- Graduated Markings Indicate Sensor Position in Extruder Head
- Designed to Offer Highest Degree of Temperature Control Over Melt Stream
- Replaces Standard Melt Bolt Thermocouples
- Ships From Stock

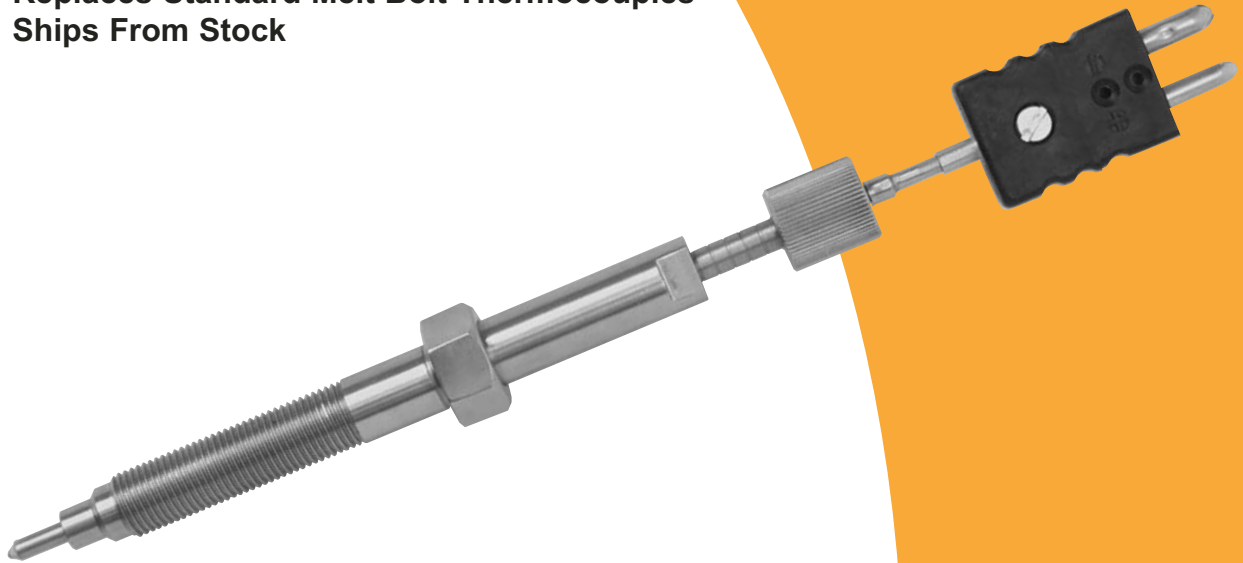

## Precision Tip Re-Adjustable Melt Bolt Thermocouple

# Product Bulletin

Pyromation's Precision Tip Melt Bolt Thermocouples are designed to withstand the stress of the plastic extrusion environment. Our precision tip design creates a positive shut off that resists the backflow of plastic into the bolt. The hardened stainless steel tip is bend resistant during operation. The design is effective in eliminating the downtime and replacement expense associated with monitoring the melt stream temperature. Graduated markings indicate the sensor position in the extruder head for simplified repeat measurements. Retractable and re-adjustable design allows for easy withdrawal from melt stream to eliminate turbulence or for complete variable immersion during full operation.



Quality in Every Degree®

5211 Industrial Road, Fort Wayne, IN 46825, USA  
phone: (260) 484-2580 • fax: (260) 482-6805 or (800) 837-6805 • [www.pyromation.com](http://www.pyromation.com)

© Copyright 2005 Pyromation, Inc., All Rights Reserved.

**PRECISION TIP RE-ADJUSTABLE MELT BOLT THERMOCOUPLE**

Pyromation's Precision Tip Re-adjustable Melt Bolt Thermocouples are supplied standard with a Type J calibration and a fast response exposed junction. Bolt lengths are available in either 3" or 6" lengths. The MgO extension "B" dimension is 1" in length. The precision tip is manufactured from hardened stainless steel and creates a positive shut off to prevent the back flow of plastic into the bolt. The 5/32" OD tip has an adjustment range of 0"-1".

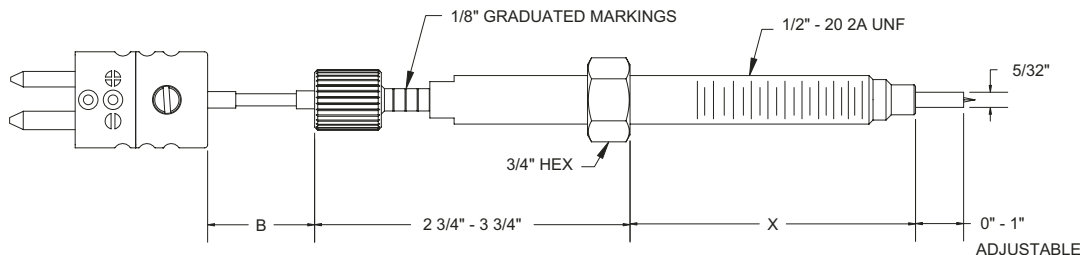

**ORDER CODES**

Example Order Number:

1-1    1-2    1-3                    1-4                    1-5                    1-6  
**JAMB 6 E - 01 - 01 - 4, MC**

**1-1 Thermocouple Type**

CODE	DESCRIPTION
JAMB	Type J Adjustable Tip Melt Bolt

**1-2 Bolt "X" Length**

CODE	LENGTH (INCHES)
3	3
6	6

**1-3 Measuring Junction**

CODE	DESCRIPTION
E	Exposed Junction

**1-6 Termination**

CODE	DESCRIPTION
4	Standard Plug 204 °C [400 °F]
<b>Options</b>	
MC	Mating Connector 204 °C [400 °F]
I	Stainless Steel Tag

**1-5 "B" Dimension**

CODE	LENGTH (INCHES)
01	1

**1-4 Tip Style and Length**

CODE	DESCRIPTION
01	5/32" OD Tip with a 0-1" Adjustment Range